



THE LEADERS IN PERFORMANCE PARTS

450KG ENGINE CRADLE

OWNER'S MANUAL

PFEENG1 / PFEENG2 / PFEENG3



WARNING

Carefully read and understand all instructions before operating. Failure to follow the safety rules and other basic safety precautions may result in serious injury.

Do not overload engine cradle beyond rated capacity.
Overloading can cause damage or failure of the engine cradle.

Always use cradle on hard, level surface capable of sustaining the engine. Use of cradle on softer surfaces can result in instability and possible loss of engine.

DIAGRAM & PARTS LIST

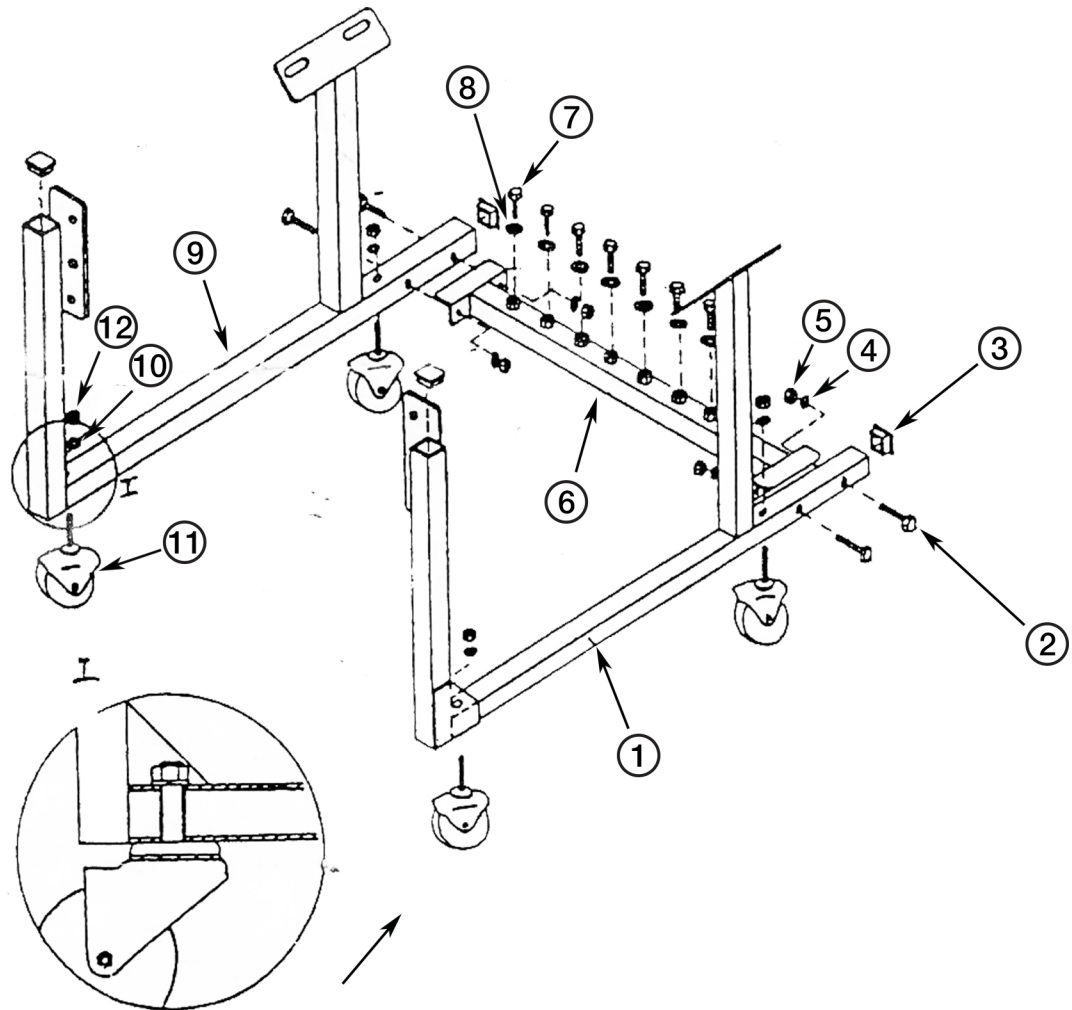

Part#	Description	Qty.
1	Right Frame	1
2	Bolt - M6 x 40	4
3	Plastic Cap	4
4	Lock Washer - M6	4
5	Nut - M6	4
6	Cross Bar	1

Part#	Description	Qty.
7	Bolt 3/8' x 16x 3/4'	8
8	Flat Washer	8
9	Left Frame	1
10	Lock Washer - M12	4
11	3' Caster	4
12	Nut - M12	4

Assembly Instrucitons

1. Attach 3' Caster (11) to Frame (1,9) using flat washers (10) and nuts (12).
2. Attach Cross bar (6) to left frame (9) and right frame (1) using bolts (2), lock washers (4) and nuts (5).
3. When repairing engine, take off flat washers (8) and bolts (7) from bar (6) and fix the engine in proper place.